



**\*\*AVAILABLE IMMEDIATELY\*\***

**\*\*UNFURNISHED\*\* \*\*STYLISH KITCHEN & SHOWER ROOM\*\*** An immaculately presented, ground floor Tyneside style flat, with two double bedrooms and recently installed modern fitted kitchen and shower room WC. Conveniently found only a stone's throw from West Jesmond Metro station and the popular restaurants and boutiques of Brentwood Avenue. This well presented property is also walking distance to the Town Moor and central Jesmond.

With over 650 sq ft of internal living accommodation, the property briefly comprises; entrance porch through to hallway with storage cupboard; bedroom one to the front, a 16ft double room with bay window and two wardrobes provided; bedroom two to the rear; lounge central to the property with spot-lighting; modern fitted kitchen with tiled flooring, spot-lights and integrated appliances; plush shower room WC with tiled walls and step in shower cubicle. Externally there is a private, south facing yard to the rear with decked area, to the front ample on street permit parking is available.

Available Immediately | £1,250pcm | 657 Sq. ft (61.0 m2) | Unfurnished | Two Double Bedrooms | Ground Floor Tyneside Flat | Modern Kitchen With Integrated Appliances | Shower Room WC | Great Location | GCH & DG | Private Rear Yard With Decking | On Street Permit Parking | Council Tax Band: B | EPC Rating: C



GROUND FLOOR  
657 sq.ft. (61.0 sq.m.) approx.

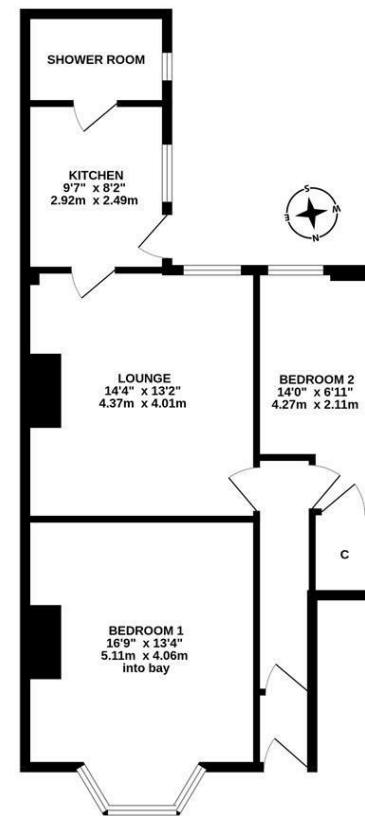

TOTAL FLOOR AREA : 657 sq.ft. (61.0 sq.m.) approx.  
Whilst every attempt has been made to ensure the accuracy of the floorplan contained here, measurements of doors, windows, rooms and any other items are approximate and no responsibility is taken for any error, omission or mis-statement. This plan is for illustrative purposes only and should be used as such by any prospective purchaser. The services, systems and appliances shown have not been tested and no guarantee as to their operability or efficiency can be given.  
Made with Metropix (2020)

**£1,250 PCM**

**IMPORTANT NOTE:** These particulars and the descriptions and measurements herein do not constitute representation and whilst every effort has been made to ensure accuracy, this cannot be guaranteed.

